

- Leading **Independent** Agents
- **20 Years** Experience in Cambridge
- Professional and Personal Service from the perspective that matters.....Yours!



16 Gisborne Road , Cambridge, CB1 3RZ Guide Price £575,000

CHAIN FREE

Attractive, 3 bed semi-detached property with a lot of potential. Excellent location close to inner ring road, Addenbrookes Hospital, local shops/schools, train station. Easy access Cambridge City centre/M11/A14. Gas central heating and double glazing. Large garden with shed & garage/workshop. Off road parking on driveway. Well maintained throughout and in good decorative order.

Downstairs :

Small open porch and front door into entrance hallway with access to under stairs storage cupboard. Carpeted. Radiator.

Reception room 1: 12' x 11'1" (3.65m x 3.37m) with bay window to front . Carpeted. Radiator.

Reception room 2: 10'11" x 10'7" (3.33m x 3.22m) . Carpeted. Radiator. Sliding door to patio and rear garden.

Galley style fitted kitchen: 13'1" x 6'8" (4m x 2.03m) with oak effect units, ceramic hob, electric built in oven , extractor fan, fridge, freezer and washer. Wood effect flooring. Door to under stairs storage area/meter cupboard. Windows to side and rear. Radiator. Side door to garden.

Upstairs:

Double bedroom 1: 11' x 10'8" (3.36m x 3.25m) with bay window to front of property. Fitted wardrobes and upper cupboards. Carpeted. Radiator.

Viewing

Please contact our Admiral Estates Office on 01223 891227 if you wish to arrange a viewing appointment for this property or require further information.



Floor Plan

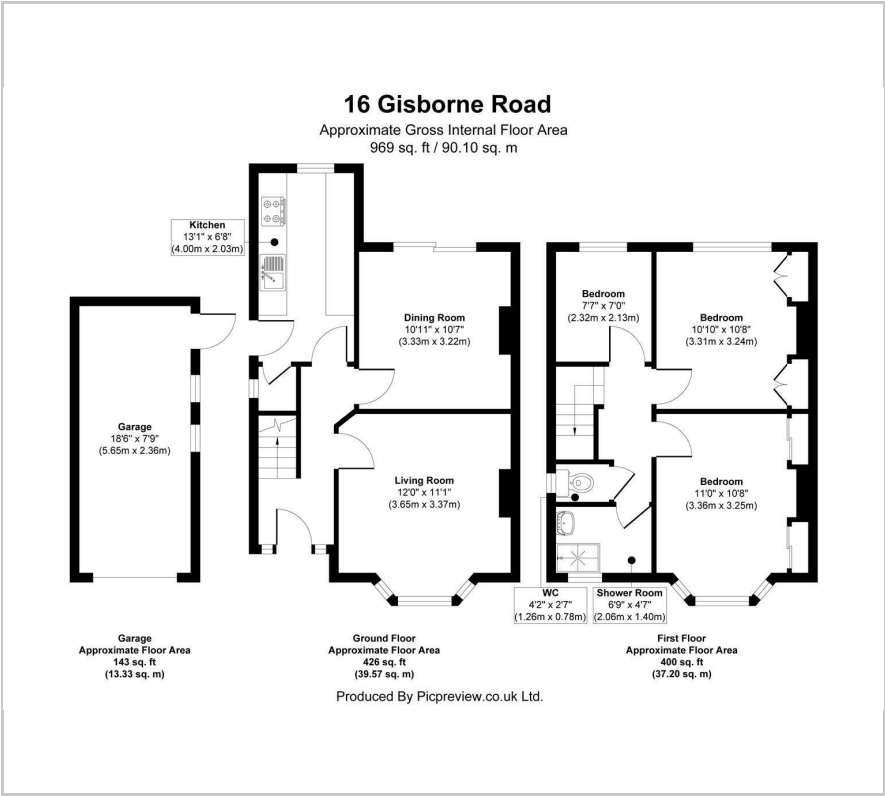

Area Map



Energy Efficiency Graph

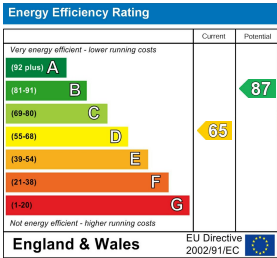

These particulars, whilst believed to be accurate are set out as a general outline only for guidance and do not constitute any part of an offer or contract. Intending purchasers should not rely on them as statements of representation of fact, but must satisfy themselves by inspection or otherwise as to their accuracy. No person in this firms employment has the authority to make or give any representation or warranty in respect of the property.